



REAL ESTATE COMPANY

INDUSTRIAL | OFFICE | COMMERCIAL  
BROKERAGE & DEVELOPMENT  
ESTABLISHED 1950

115,400 SF  
FOR LEASE



## 10800 AMBASSADOR DRIVE KANSAS CITY, MO

OFFICE AND WAREHOUSE BUILDING

### FEATURES

- 8,000 +/- SF office area
- 50' x 50' column spacing
- 9 dock-high doors
- 359 parking spaces
- 28' x 30' clear ceiling height
- Multiple production areas
- 4,000 amps, 3-phase power
- Great access and visibility to I-29

BASE RATE:  
**\$5.95/SF NNN**

NET CHARGES (EST):

Taxes: \$1.64/SF

Insurance: \$0.13/SF

CAM: Self-performed by tenant

For more information  
please contact

**JOHN DELZER**  
jd@karbank.com

**PAUL FOGEL, SIOR**  
pf@karbank.com

THE BARNEY BUILDING  
2000 SHAWNEE MISSION PARKWAY  
SUITE 400  
MISSION WOODS, KS 66205

816.221.4488  
816.221.4494

KARBANK.COM

Information furnished regarding property is from sources deemed reliable but no warranty or representation is made as to the accuracy thereof and same is submitted subject to errors, omissions, prior sale or lease or withdrawal without notice.



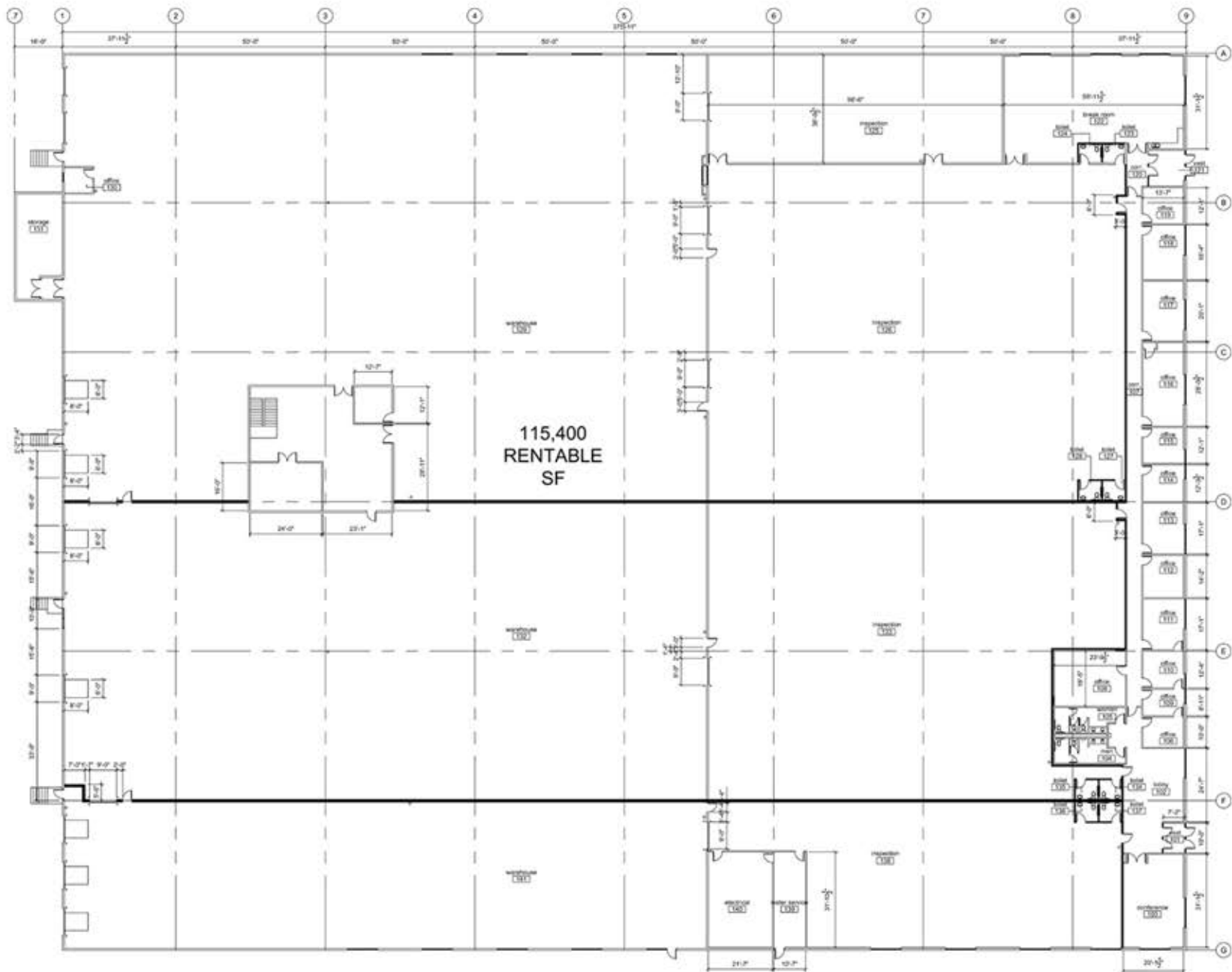

**KARBANK**  
REAL ESTATE COMPANY

THE BARNEY BUILDING  
2000 SHAWNEE MISSION PARKWAY | SUITE 400  
MISSION WOODS, KANSAS 66205  
[KARBANK.COM](http://KARBANK.COM)

ADDRESS **10800 N. Ambassador Drive  
Kansas City, MO**

PLAN TYPE **Floor Plan**

TOTAL SF  
**115,400 SF**

TOTAL OFFICE SF

DATE  
**2-7-2023**

SCALE

