

**16850 WEST  
119TH STREET  
OLATHE, KS**

**119TH STREET TECH PARK  
BUILDING 4**



## FEATURES

- Flexible for many uses:
  - office
  - flex
  - lab
  - medical
  - manufacturing
  - call center
- Fully sprinklered building
- Dock-high loading
- 6-8 per 1,000 parking ratio
- Ample power
- Divisible
- Excellent access off of I-35 and 119th Street
- Available 4-1-2024
- \$12.95/SF NNN



## CONTACT DETAILS

✉ JOHN DELZER  
jd@karbank.com

✉ PAUL FOGEL, SIOR  
pf@karbank.com

☎ 816.221.4488  
816.221.4494 fax

🌐 karbank.com

Information furnished regarding property is from sources deemed reliable but no warranty or representation is made as to the accuracy thereof and same is submitted subject to errors, omissions, prior sale or lease or withdrawal without notice.

**FIRST FLOOR**

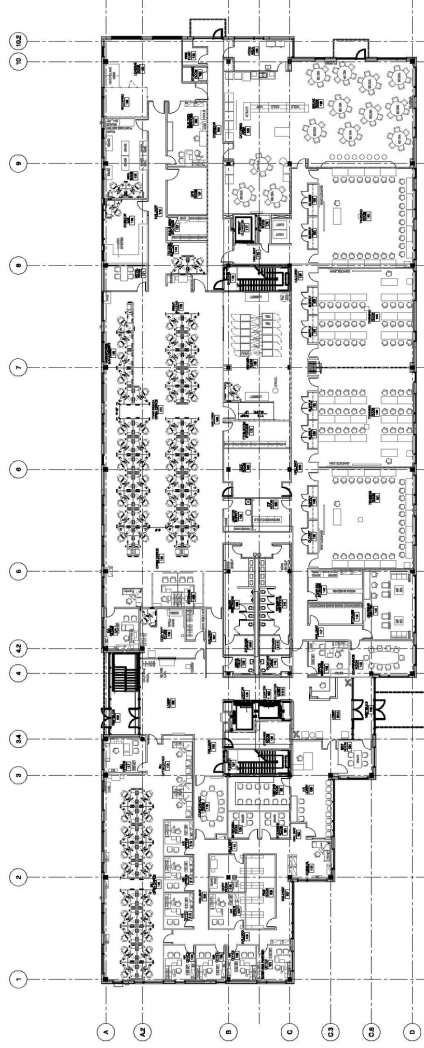

**SECOND FLOOR**

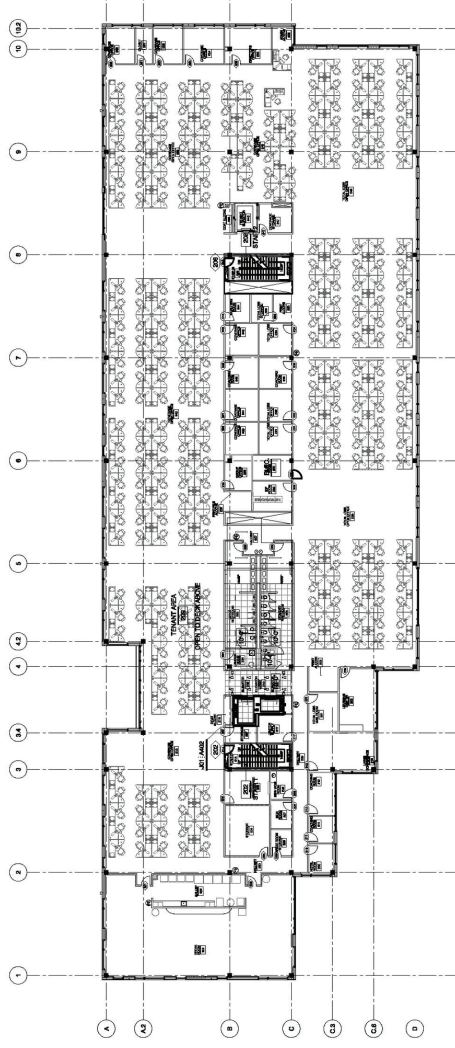

**THIRD FLOOR**

